

Do not scale this drawing. Work to figured dimensions only. This drawing is copyright of APS Designs and should only be reproduced with their express permission. Check all dimensions on site. Any discrepancies should be reported to APS Designs prior to commencement.

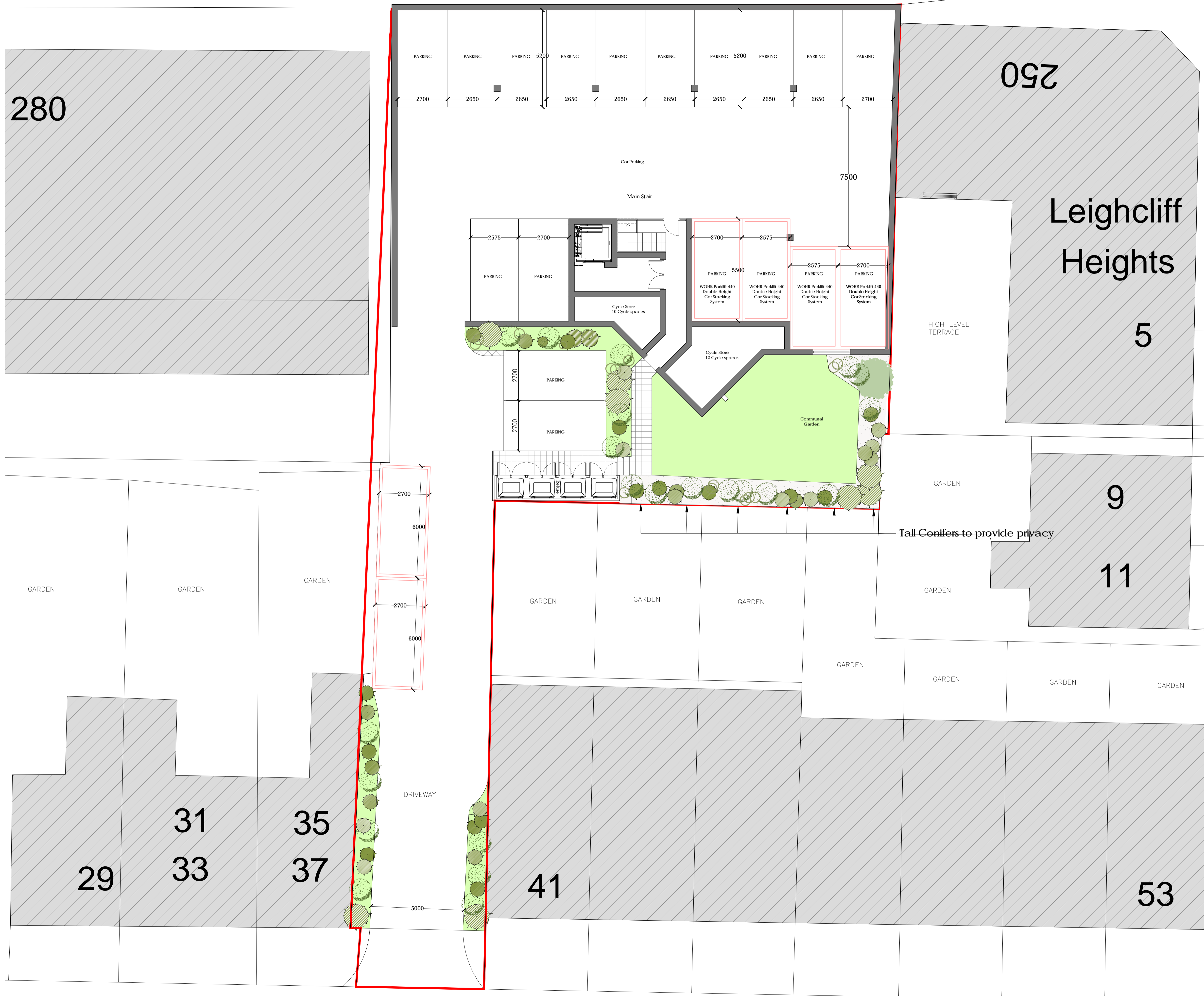

1 Proposed Lower Ground (Parking)

Scale: 1:100

REVISION	DATE	AMENDMENT
D	03-04-2017	Added Annotation to boundary planting
C	10-11-2016	Added planting and altered parking spaces
B	09-11-2016	Added guest parking spaces + bin stores rearranged
A	07-11-2016	Revised Parking Layout to east

APS DESIGN ASSOCIATES LTD
 ARCHITECTURAL DESIGNERS AND PLANNING CONSULTANTS

PROJECT STAGE: Town Planning
 DRAWN BY: TE
 DATE: 07-11-2016

CLIENT:
 PROJECT: 258 Leigh Road
 JOB NO: 2408
 DRAWING TITLE: Proposed plans
 The Design Studio
 1 Cambridge Road (Rear)
 Nelson Street
 Southend-On-Sea
 Essex
 SS1 1ET

DRAWING NO: 03
 REVISION:
 SCALE: 1:100 @ A1
 Tel: 01702 469 769 - 01702 337328
 Email: admin@apsdesignsuk.com
 designsteam@apsdesignsuk.com
 planning@apsdesignsuk.com
 Website: www.apsdesignsuk.com